

5 Community Facilities and Services

This section of the report considers the range of community facilities and services currently provided within the town of St. Germain. Based upon the subsequent inventory, deficiencies and opportunities will be identified, and recommendations will be made relative to future town needs.

The facilities and services inventoried include: administrative facilities/services, schools, protective services (police, fire, rescue), public buildings, solid waste management/recycling, communication and power, transportation (will be put into its own section), public sewer and water accommodations, and stormwater management. Map 5-1 identifies the location of the existing community facilities within the town of St. Germain.

5.1 Administrative Facilities/Services

The town of St. Germain's administrative facilities/town offices are housed in an old brick school building which is located at the intersection of STH 70 and STH 155. This 12,000 sq. ft. building was constructed in 1941. The building was recently converted to town offices in 1997; previously the building served as one of three elementary schools in the Northland Pines School District. Currently, only approximately one-third of the building is being used, therefore it has adequate space available to meet the town's future needs. The town plans to study the options of remodeling or new construction in the near future. Town administration is handled by a five member town board and an elected clerk and treasurer. The administration's staff consists of two full-time and two part-time maintenance crew positions, one part-time deputy treasurer who assists the treasurer with tax collection, and a town zoning administrator.

The town board meets the second Monday of every month at the community center, located adjacent the building which houses the town offices. The five members on the town board serve two year terms .

The town board oversees the following committees which are responsible for various town functions.

Zoning and Planning Committee

Oversees the zoning and planning issues including review of development and building applications, administration of zoning regulations, land use plan development, and town recreation facilities.

Senior Housing Committee

Oversees senior housing within the town which currently consists of two apartment buildings.

Golf Course Committee

Oversees the operations of the St. Germain Public Golf Course.

Public Works Committee

Oversees the town road system, transfer station, and town employees.

Finance Committee

Oversees the financial needs of the town.

Room Tax Commission

Oversees the collection and expenditure of the room tax. This committee was recently appointed in June 1998.

5.2 Schools

Educational facilities for the town of St. Germain are provided by the Northland Pines School District. Facilities for elementary education (K-5) are located in St. Germain, Eagle River and Land O' Lakes, while middle school and high school facilities are located in Eagle River. In addition, there are two private schools located in Eagle River. This section analyzes these facilities which service the town of St. Germain.

The St. Germain Elementary School for grades kindergarten through 5 was recently opened in 1997, and is located in St. Germain. The facility is 48,000 square feet, and has a maximum capacity of 381 students. Prior to the construction of this facility, elementary students attended the old school building located at the intersection of STH 70 and STH 155 which is now the town hall. The 1997-98 enrollment for the elementary school was approximately 166 students in grades K-5. The school is set back from the highway and a significant plot of forested land separates the facility from the highway. The community provided input regarding the structure, and as a result this school has attained a "Northwoods" feel. A pine tree motif was incorporated into bathroom tiles, and the gymnasium has floor to ceiling trees in each corner.

In addition to the elementary school in St. Germain, the Northland Pines School District also provides elementary facilities in Eagle River and Land O' Lakes. The facility in Eagle River is included with the Northland Pines Middle School facility, and will be discussed in detail under the middle school section. The Land O'Lakes facility which opened in 1997 provides education to grades K-2. This facility, like the one in St. Germain, is 48,000 square feet, and has a maximum capacity of 381 students.

TOWN OF PLUM LAKE, VILAS COUNTY
T 41 N, R 7 E

TOWN OF PLUM LAKE, VILAS COUNTY
T 41 N, R 8 E

MAP 5-1 COMMUNITY FACILITIES AND SERVICES Town of St. Germain Vilas County, Wisconsin



State of Wisconsin

Community Facilities and Services

- 1 - Town Hall
- 2 - Community Center
- 3 - Fire Station
- 4 - St. Germain Elementary School
- 5 - Cemetery
- 6 - Downtown Park
- 7 - Informational Booth
- 8 - St. Germain Golf Club
- 9 - Transfer Site
- 10 - Recycle Drop-Off Site
- 11 - Lost Lake Park

Town Border

Parcel Lines

Surface Water

Local Roads

County Roads

State Roads

Section Numbers

Inset



This drawing is neither a legally recorded map nor a survey and is not intended to be used as one. This drawing is a compilation of records, information and data used for reference purposes only.

Source: Vilas County, 1997

0 2000 4000 6000 8000 10000 Feet



303004949496_5.dwg 03/06/2019 10:01

TOWN OF ARBOR VITAL, VILAS COUNTY
T 40 N, R 7 E

TOWN OF CLOVERLAND, VILAS COUNTY
T 40 N, R 8 E

TOWN OF WOODRUFF, ONEIDA COUNTY
T 40 N, R 7 E

TOWN OF NEWBOLD, ONEIDA COUNTY
T 40 N, R 8 E

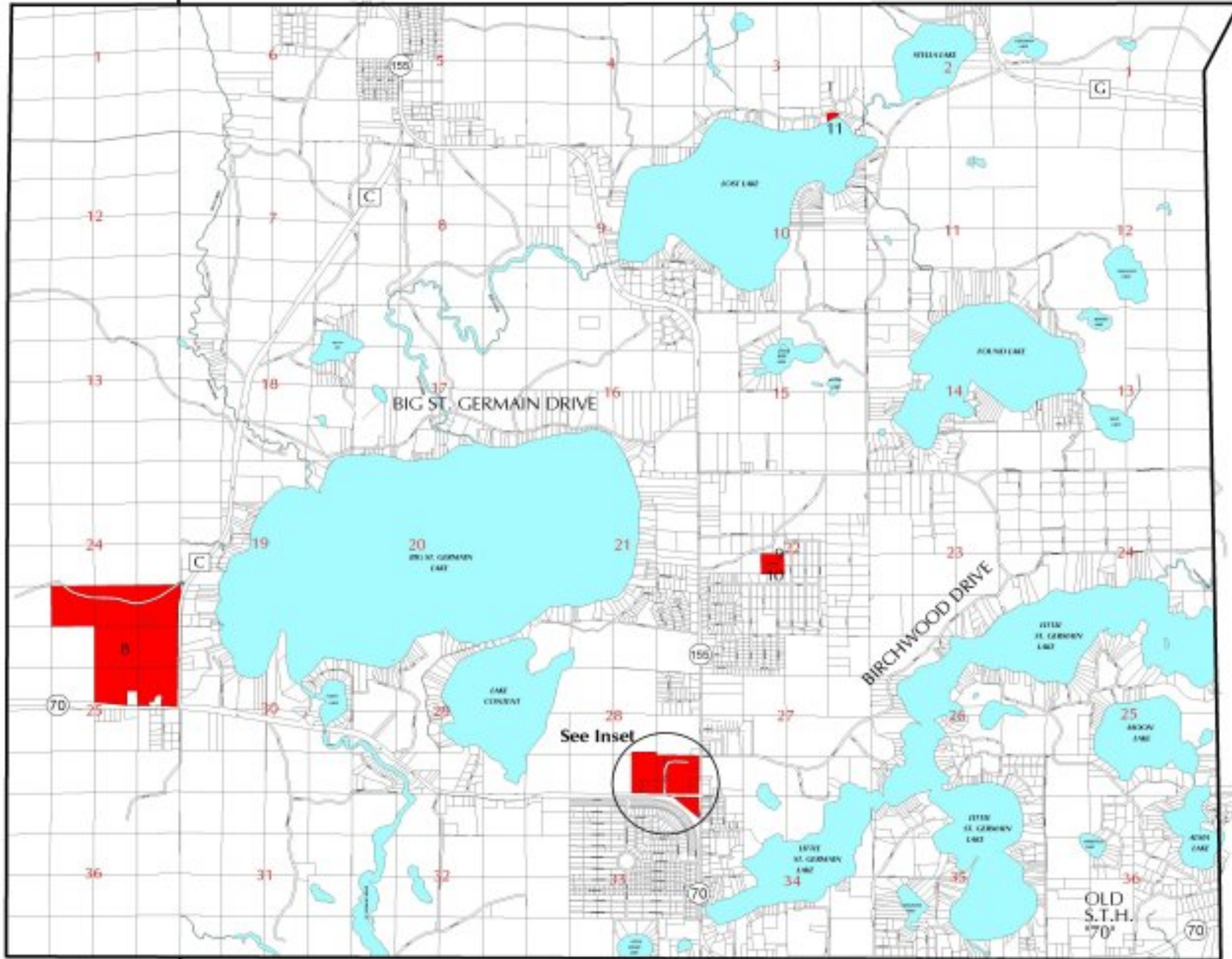

The Northland Pines Middle School is located in the city of Eagle River, and provides education to students in grades 6-8. This facility also houses elementary students in grades K-5 (as indicated above). It was constructed in 1994 and is 160,000 square feet. The current 1997-98 enrollment is 434 students in grades 6-8, and approximately 380 students in grades K-5 (Total = approximately 814 students). The maximum capacity of the facility is 1,230 students.

The Northland Pines High School, also located in Eagle River, houses grades 9-12. This facility was constructed in 1975, and is 120,000 square feet. Current enrollment for the 1997-98 school year is 515 students. The school's maximum capacity is 600 students.

Table 5-1 provides the actual enrollments for the Northland Pines School District from the 1991-92 school year through 1997-98, while Figure 5-1 illustrates the enrollment figures based on grade school, middle school, high school and total enrollment.

**Table 5-1
Northland Pines School District Actual Enrollments
1991-92 Through 1997-98**

Grade	1991-92	1992-93	1993-94	1994-95	1995-96	1996-97	1997-98
Pre-K	-	-	-	-	-	-	14
K	115	104	97	115	109	118	109
1	117	103	98	92	129	109	105
2	109	113	108	107	80	129	104
3	99	104	125	125	110	87	128
4	105	101	106	136	121	112	93
5	104	119	104	118	134	129	120
6	109	118	118	125	130	162	137
7	110	112	132	124	126	131	158
8	112	106	111	129	132	120	139
9	123	117	112	129	129	139	118
10	96	128	115	116	131	138	136
11	106	98	132	124	117	135	136
12	120	116	98	132	118	99	125
TOTAL	1,425	1,439	1,456	1,572	1,566	1,608	1,622

Figure 5-2 provides enrollment projections out to the school year 2002-03. The projections anticipate a very slight growth in student enrollment through the school year of 2001-02, increasing from the 1997-98

enrollment of 1,622 students to 1,645 students in 2001-02. This is an increase of 23 students, or only 1.4%. Student enrollment is then projected to decrease in the school year 2002-03 to 1,634 students.

Figure 5-1
Student Enrollment
Northland Pines School District
1991-92 - 1997-98

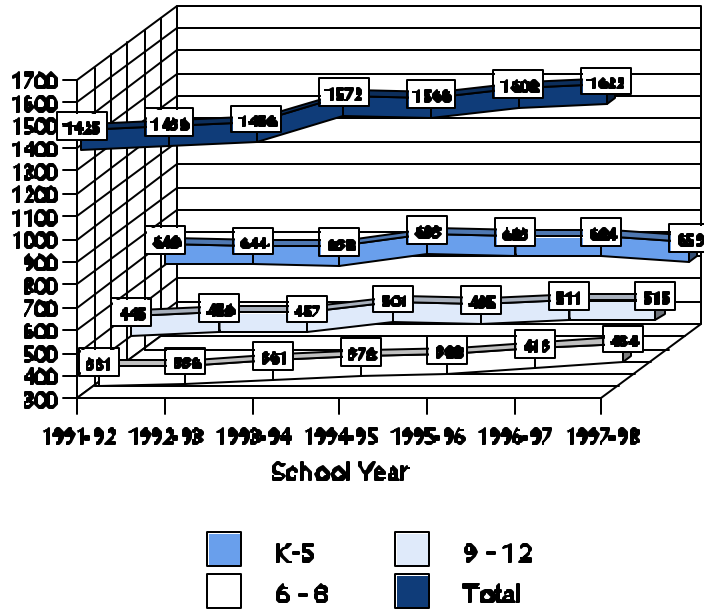

Source: Northland Pines School District

**Figure 5-2
Northland Pines School District Projected Enrollments
1997-98 Through 2002-03**

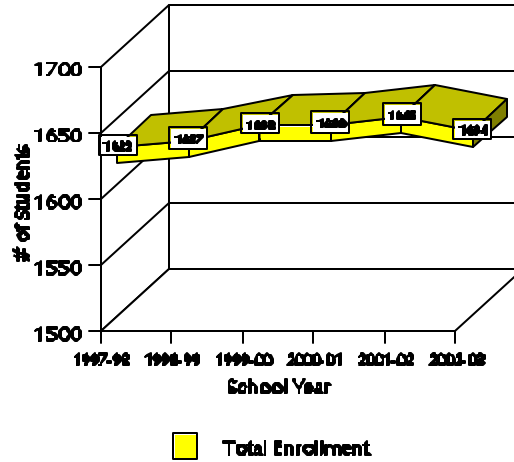

Source: Northland Pines School District

Currently, all K-8 facilities in the Northland Pines School District area state of the art facilities. All of the elementary schools have family resource centers, distance learning labs, computer labs, etc. Therefore, these facilities are meeting the needs of the population and are expected to continue to meet future needs. The high school facility, however, is not projected to meet future needs. Three referendums have failed between 1998-1999 relative to building improvements and teacher positions. It is anticipated that the high school will need extensive remodeling/renovating and/or additions, or even replacing.

In addition to the public school facilities provided by the Northland Pines School District, there are two private schools within the area. These educational facilities include Christ Lutheran School and St. Peter's Catholic School, both of which are located in Eagle River. Christ Lutheran School provides educational instruction for preschool and kindergarten through eighth grades. Christ Lutheran School is located at 111 N. 3rd Street in Eagle River. Total school enrollment for the 1997-98 school year was 70 students. St. Peter's Catholic School is located at 115 S. 3rd Street in Eagle River. St. Peter's provides educational instruction for preschool, and kindergarten through fifth grades. The 1997-98 school enrollment was 75 students.

5.3 Protective Services

Protective services include the police, fire and rescue services which are provided to the town.

Police Protection

Police protection services for the town are provided by the Vilas County Sheriff's Department which is located in Eagle River. Since May 8, 1997 there have been 450 calls to the town. Data prior to that date is not readily available as the county installed a new computer system in May, 1997. In addition to the county's services, the town of St. Germain employs a part-time local constable that does not have any ordinance enforcement power. There are no immediate needs, but there have been discussions about establishing a Lake Patrol Service with the Vilas County Sheriff's Department.

Fire Protection

The town's fire services are provided by the St. Germain Volunteer Fire Department which is located at the intersection of STH 155 and STH 70. Fire protection was the highest rated town service according to the 1997 community planning survey.

There are approximately 20 - 30 volunteers which staff the department. The department has received an average of 30 calls per year over the last five. Equipment owned by the department includes two pumper trucks, one tanker truck, one ladder truck (65'), one brush/hydrant truck, one rescue squad van, a snowmobile, ambulance, jaw, and an inflatable boat with a 25 h.p. motor.

The adequacy of fire protection in the town is evaluated by the Insurance Service Office (ISO) through the use of the *Grading Schedule for Municipal Fire Protection*. The schedule provides criteria to be used by insurance grading engineers in classifying the fire defenses and physical conditions of municipalities. Gradings obtained under the schedule are used throughout the United States in establishing base rates for fire insurance. The grading is obtained by ISO based upon their analysis of several components of fire protection including fire department equipment, alarm systems, water supply system, fire prevention programs, building construction, and distance of potential hazard areas from a fire station. In rating a community, the areas of evaluation are assigned a numerical rating of one to 10, with 1 representing the best protection and 10 representing an essentially unprotected community. Class nine usually indicates a community without an effective public water supply or hydrant protection. The town of St. Germain's current ISO rating is eight, but is expected to be six upon reevaluation. This rating is likely due to the fact that there is no public water supply within the town.

The department has joint service agreements with adjacent town, including Plum Lake, Cloverland and Newbold. There is also a county-wide mutual aid agreement involving all eleven fire departments in the county. The mutual aid agreement is a formal agreement whereby the fire departments will help each other, if needed, at no charge. St. Germain is also involved in mutual aid agreements with towns of Sugar Camp, Newbold, Lake Tomahawk, and Woodruff, all of which are located in Oneida County. In addition, the town has an automatic agreement with the town of Plum Lake whereby Plum Lake's fire department will automatically be called for certain degrees of fires, and vice versa. This agreement helps in maintaining a good ISO rating. A new fire station was built in 1997-98. Presently, the department is up to date and there are no immediate needs.

Rescue/First Responder

The town of St. Germain's fire department provides first responder services in addition to fire protection. Results from the community planning survey indicate rescue services as the second-highest rated town service, following closely behind fire protection.

Currently, there are 15 qualified volunteer first responders which provide basic care until paramedics arrive. St. Germain's first response team received an average of 120 calls per year over the past five years, and this number is estimated to increase over the next five. The fire department owns a new rescue van for providing first response services. Plum Lake provides 95% of the emergency transportation for the town. Greater than 90% of emergencies are taken to Howard Young Medical Center and Eagle River Hospital. The town would like to obtain defibrillator equipment and corresponding training in the near future.

5.4 Public Buildings

All of the town's public buildings are located at the intersection of STH 70 and STH 155. These buildings include the 15,000 sq. ft. community center (constructed 1978) which is an old building used for a variety of community functions including town meetings, fund raisers, and gymnasium facilities. There is also an old brick school building which houses the town offices. A new fire department building and a new town maintenance building were both constructed adjacent the community center and town office building in 1997-98. The snowmobile club is also housed on the town's property at this location.

The nearest public library to the town of St. Germain is the Plum Lake Library, located in Sayner, which is approximately 7 miles away. The library's hours of operation are: Monday: 1:00 pm - 7:00 pm, Tuesday: 10:00 am - 1:00 pm; Wednesday: 10:00 am - 12:00 pm, 1:00 pm - 7:00 pm; Thursday: 1:00 pm - 5:00 pm; Friday: closed; and Saturday: 10:00 am - 1:00 pm.

There is an information booth located at the southwest corner of the intersection of STH 70 and STH 155 in the southern portion of the town.

5.5 Solid Waste Management/Recycling

Refuse collection service is provided to town residents by means of individual resident/business contracts with private haulers. Residents may, however, bring refuse in purchased refuse bags to a garbage drop-off site at the transfer site which is open five days per week in summer, and four days per week in winter. The hours of operation are as follows: summer - Sunday, Monday, Wednesday and Friday from 8:00 am - 1:00 pm, and Saturday 8:00 am - 4:00 pm, and winter - Monday - Wednesday 8:00 am - 12:00 pm and Saturday 8:00 am - 4:00 pm. The transfer site is located off of STH 155 on Pedycourt Road. The landfill which services St. Germain is the CTH G landfill which was opened in 1990. This landfill has a projected lifespan of 30 years, therefore it should be viable through the year 2020. According to the town of St. Germain Community Planning Survey conducted in August of 1997, garbage collection was rated the lowest overall in level of service compared to other town services.

The town provides a recycling drop site which is open to the public. This is also located at the transfer site off of STH 155. The recycling site is open six days per week, including Monday - Saturday, from 7:30 am - 3:00 pm, and is closed on Sunday. This form of recycling program is performing well for the town.

5.6 Communication and Power Facilities

This section includes electric power, natural gas, telephone and cable services which are provided to the town of St. Germain.

The town's electrical power services are provided by Wisconsin Public Service (WPS). Natural gas was recently (1998) installed throughout the town. Basic telephone service is provided by GTE, and cable service is available through Lakeland Cable Service.

5.7 Public Sewer Accommodations

The town of St. Germain currently does not have public sewer system accommodations; individuals and businesses have their own septic systems. The Town of St. Germain Community Planning Survey asked property owners whether or not the town should investigate the development of sanitary sewers for the highly developed areas within the community. Responses to the question were mixed, however more people felt that the town should investigate sanitary sewers (40.3%), than not (35.8%). The remaining respondents had no opinion.

5.8 Public Water Supply

There is no existing public water supply within the town of St. Germain. Private wells supply the entire town's water needs. The community planning survey distributed in the town of St. Germain asked whether or not the town should investigate the development of a public well water supply. The majority of responses were against such investigation (51.5%), while only 26.7% of residents felt a town public well water supply should be investigated. The remaining respondents had no opinion (21.7%).

5.9 Public Facilities and Services Recommendations

The following public facilities and services recommendations were developed based on the information contained in this section of the plan, as well as from discussions with town officials and other town representatives.

- ◆ The town should continue to invest in new public works equipment and maintain existing equipment in order to adequately, and economically, perform required duties.
- ◆ The town should investigate the feasibility of installing a public sanitary sewer system. There is considerable interest by town residents for the town to further study this issue based on the

results of the community planning survey. This issue will become increasingly important as residential and commercial development increase within the town.

- ◆ The town should maintain active involvement in the plans to remodel or reconstruct the existing high school facility to ensure the adequacy of educational facilities for St. Germain school-age children.
- ◆ The town should continue its joint fire service agreement with adjacent townships including the towns of Sayner, Cloverland, and Newbold, as well as its involvement in mutual aid agreements with Vilas County and the towns of Sugar Camp, Newbold, Lake Tomahawk, and Woodruff which are located in Oneida County, and its automatic agreement with the town of Plum Lake.
- ◆ The town's solid waste management practice of individual resident/business contracts with private waste haulers is currently working favorably for the community. The town should however, periodically monitor the effectiveness of this type of waste management with residents and property owners. In the event that a significant number of seasonal homes are converted to year-round residences, the town should investigate providing waste hauling services.
- ◆ The recycling drop site is currently operating effectively for the town. However, the town should periodically monitor the operations of the site to ensure its convenience for town residents and property owners.
- ◆ The town's potable water situation should be monitored every several years; as both residential and commercial development continue to occur, the town should investigate the "cost-effectiveness" of installing a public water supply system.
- ◆ The town should entertain a feasibility study for town administrative service buildings (including the red brick town offices and community center) relative to options for future use, accessibility, and service to the community.